

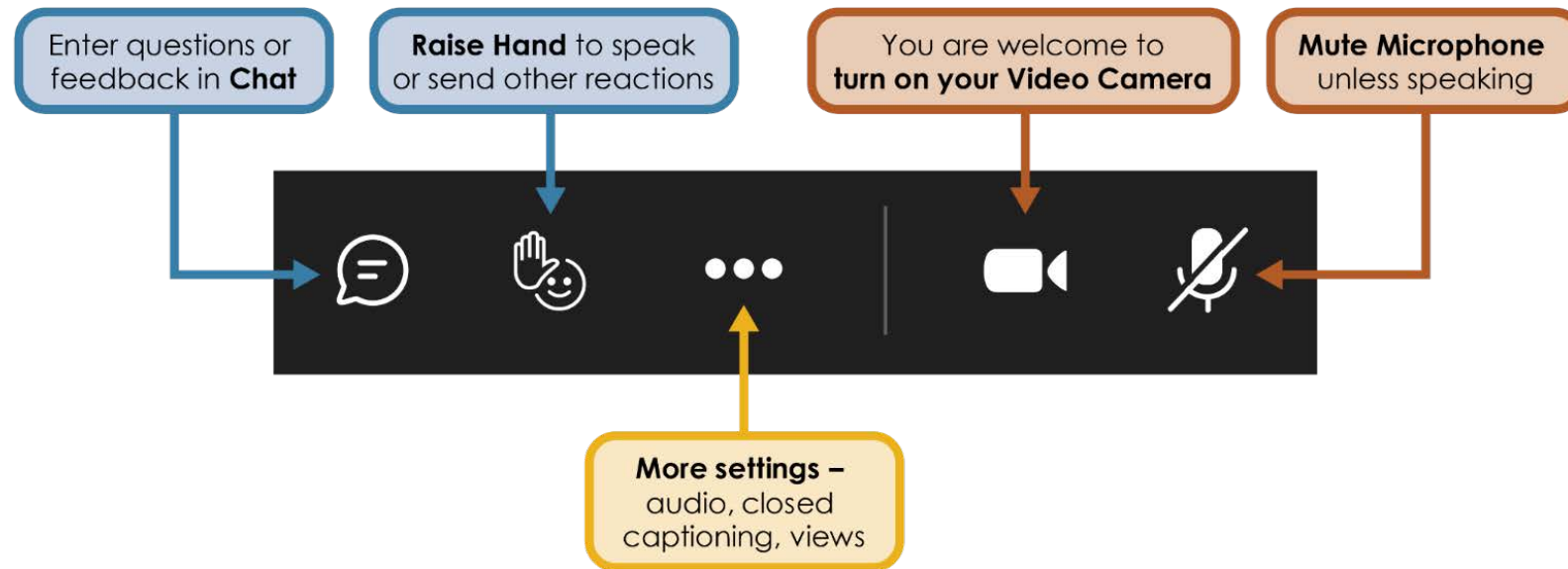

Advanced Practice and Pain Management Rule

Jessilyn Dagum, Policy Analyst

Zoom Features We Will Use Today



Meeting Reminders

- Be mindful and respectful of all those in attendance.
- Please raise your hand to speak and staff will call on you to share.
 - State your name before speaking.
 - Speak clearly and audibly.
 - Keep your mic muted unless asked to share.
- Please be mindful of the time and allow others the opportunity to speak.
- Please stay on topic: Advanced Practice and Pain Management Rule

Background

The rulemaking we are discussing today pertains to the advanced practice and pain management rules. The CR-101 for this rulemaking was filed under WSR 25-15-033 on July 8, 2025.

Amends: WAC 246-840-010 and 246-840-300 through 246-840-4990 to:

- clarify advanced practice licensure requirements
- align standards with national best practices
- update prescriptive authority provisions
- address other related objectives.

This rulemaking is Phase 2 of the board's review of chapter 246-840 WAC, conducted in accordance with the board's five-year formal rule review process under RCW 43.70.041.

The overall goal of this review is to clarify and update outdated language, rewrite and reformat existing rules to reflect current best practices, and restructure sections as necessary.



Washington State Board of Nursing
8/21/2025

Proposed Rule Development Timeline (Tentative)

- July 2025 – CR101 Filed
- August 2025 – Interested Party Work Begins (workshops and drafts)
- January 2026 – Board Review of Draft Proposed Rule and CR-102
- February 2026 – CR102 Filed
- March 2026 – Public Rule Hearing
- April 2026 – CR103 Filed
- May 2026 – Rule Effective



Guidance/Recommendations

- Prescriptive Authority: Opt-out vs. Opt-in
- Clinical Practice Hour Requirement
- List of Approved Certification Examinations and Certifying Bodies
- Clarifying Requirements for RN and ARNP Continuing Education Requirements and English Proficiency Exam
- Condense Pain Management Rules

Discussion Questions

- What challenges or barriers have you experienced with the current language?
- Are there terms or sections that are unclear or outdated?
- How could these rules be more reflective of current practice?
- Are there areas where alignment with national norms or expectations is lacking?

Next Steps

Next Rule Workshop:

Wednesday, September 17, 2025 Via Zoom

Questions? Email WABONRules@doh.wa.gov or visit our website:
<https://nursing.wa.gov/laws-rules-and-statements/rules/rules-progress>