

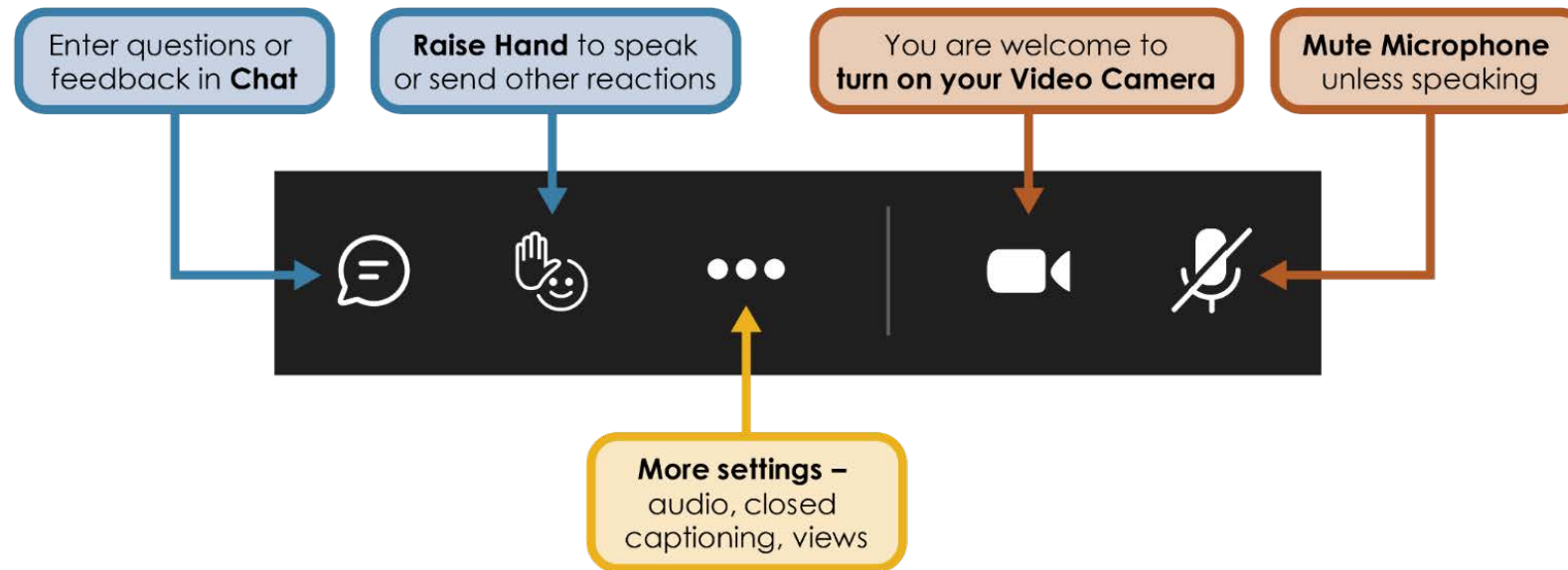

# RN/LPN Licensing and Continuing Competency Rulemaking

Jessilyn Dagum, Policy Analyst

# Zoom Features We Will Use Today



# Meeting Reminders

- Be mindful and respectful of all those in attendance.
- Please raise your hand to speak and staff will call on you to share.
  - State your name before speaking.
  - Speak clearly and audibly.
  - Keep your mic muted unless asked to share.
- Please be mindful of the time and allow others the opportunity to speak.
- Please stay on topic.

# Phase 1: RN/LPN Licensing and CC Rules

The Washington State Board of Nursing (board) is considering amendments to WAC 246-840-015 through 246-840-260 to:

1. Clarify and update outdated language;
2. Rewrite and reformat existing rules to reflect current best practices; and
3. Restructure sections as necessary

The purpose of this rulemaking is part of the board's 5-year formal rule review process in accordance with RCW 43.70.041. The board is conducting this review in a phased approach. This rulemaking is Phase 1 of the board's formal review process.



# Specific Objectives

1

Simplify Barriers  
for Multistate  
Licensure  
Applicants

2

Reduce Barriers  
for Applicants  
Educated Outside  
the United States

3

Explore limiting  
NCLEX Attempts  
Before  
Remediation

4

Incorporate  
Legislative  
Updates



# Discussion Questions

1. What do you find confusing or unclear about this WAC?
2. Are there any barriers or challenges with the current language?
3. How could the language be improved?



# Review Draft Language



# Upcoming Rule Workshops

- **February 25 from 3:30 - 5 PM: Review WAC 246-840-015 through 260**
- **February 27 from 3 - 4:30 PM: Review WAC 246-840-015 through 260**
- **March 4 from 3 - 4:30 PM: Review WAC 246-840-015 through 260**



# Next Steps

- Subscribe to the board's GovDelivery messaging system for the latest rulemaking announcements.
- Review the workshop materials prior to the next rule workshop

Questions? Email [WABONRules@doh.wa.gov](mailto:WABONRules@doh.wa.gov)